

APPROVED BY THE CITY COUNCIL OF THE CITY OF
 SAN BERNARDINO AT ITS MEETING OF Oct. 20, 1911.

J. J. Batchelor CITY CLERK

Filed December 28, 1911.
Paul J. Smith
 City Engineer.

No. 100*
 PLAN AND SECT
 OF E. STRE
 IMPROVEMENT
 FROM SOUTH LINE
 3rd STREET TO N
 LINE OF 2nd STR

EST

12' 6" & 12' 6"

normal - height "A"

EST

EST

12th & 13th

Normal - 100 ft "A"

EST

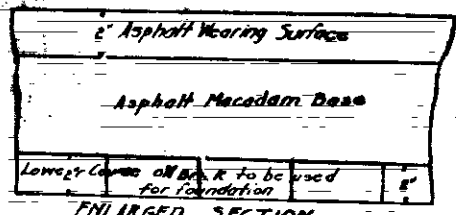

ENLARGED SECTION OF ROADBED SCALE 3" = 1'

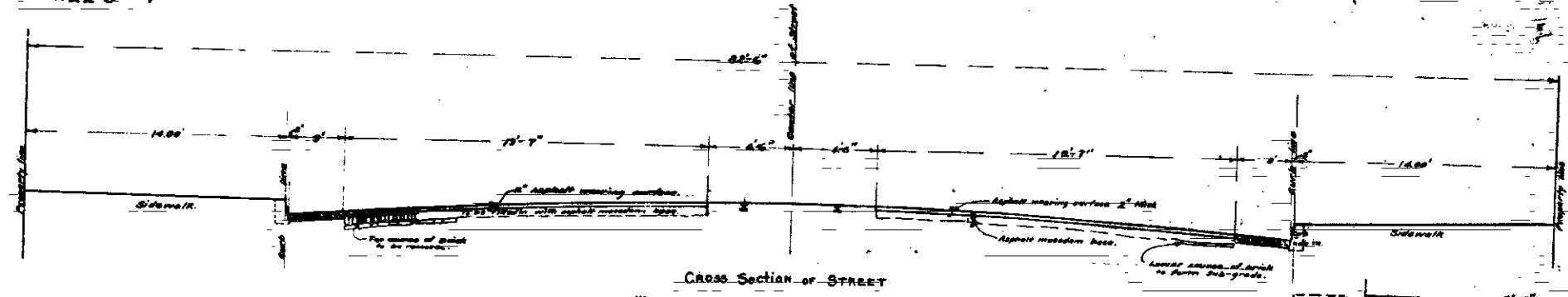

CROSS SECTION OF STREET
WIDTH OF PAVEMENT 18'7" on each side of S.B.V.T. Co.
SCALE 1" = 4' FT.

Grade of center line of street to be at ordinance grade.
Cross Sections modified according to formula $a = \frac{p}{n}$
Where a = depression of quarter point.
 p = height of crown above gutter.
 n = no. of sections of half street.

ABBREVIATIONS
THE SYMBOL (') AND FT. INDICATES FOOT OR FEET
THE SYMBOL (") AND IN. INDICATES INCH OR INCHES
THE SYMBOL = INDICATES EQUALS
N# INDICATES NUMBER
INDICATES ASPHALT PAVING
INDICATES CONCRETE GUTTER
INDICATES CONCRETE IN SECTION

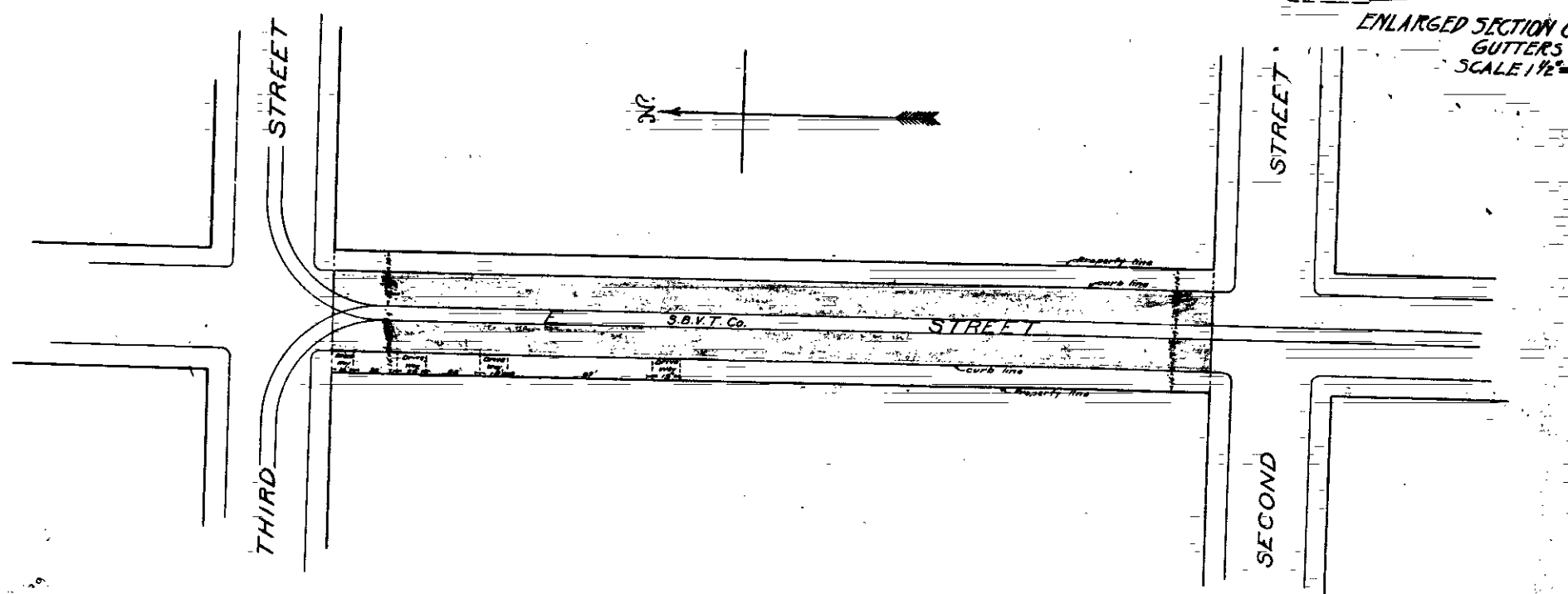

ENLARGED SECTION OF GUTTERS SCALE 1 1/2" = 1'

APPROVED BY THE CITY COUNCIL OF THE CITY OF
SAN BERNARDINO AT ITS MEETING OF Oct. 20, 1911.

J. H. Batcher CITY CLERK

Filed December 28, 1911.
Paul ...
City Engineer

No. 1000
PLAN AND SECTION OF E. STREET IMPROVEMENT FROM SOUTH LINE 3rd STREET TO NORTH LINE OF 2nd STREET